

User manual

2021-03-08

CuroCell Cirrus® 2.0

Alternating pressure system

User manual item number: 95-001283



Contents

Important safety precautions	3
Introduction	4
Product description	8
Assembly/Installation	11
Operation	12
Cleaning and reconditioning	14
Storage	15
Maintenance	16
Troubleshooting	17
Technical description	18
Spare parts	20
Options and accessories	21
Warranty	22
Other information	23

IMPORTANT SAFETY PRECAUTIONS

Read all instructions prior to use

WARNING! To minimise the risk of fire, electric shocks or bodily injury:

- 1 The product must only be used for its intended purpose as described in this manual. The product may not be combined, assembled or repaired with other parts (e.g. pump and mattress), accessories or spare parts other than those described in this manual or other documentation from Care of Sweden.
- 2 Do not use the pump in wet rooms or where there is a risk of the pump coming into contact with water or another liquid. Never handle a pump that has come into contact with water/liquid. Pull the plug out of the electrical socket immediately and send the product to an authorised service technician for servicing.
- 3 DO NOT USE in the vicinity of or in contact with fire sources/hot surfaces, such as fire, burning cigarettes or hot lamps. Although the product has undergone fire testing, it could become damaged if it comes into contact with fire sources.
- 4 Position and use the product in a manner that prevents it from becoming trapped or damaged. NOTE: Be particularly aware of trapping damage when using bed rails.
- 5 Never use the product if the pump power cord or plug is defective, the pump casing is damaged or it is not functioning properly. Contact a service technician for examination and repair.
- 6 Regularly check product functionality through a hand check (see section 4.4). Also check that the comfort setting is correct as indicated in the table on the pump.
- 7 Continual monitoring is required when the product is used for individuals needing special supervision, such as children.
- 8 The mattress is protected by a hygiene cover; avoid using multiple hygiene covers as this can affect the vapor permeability of the mattress.
- 9 The hygiene cover does not allow liquid or air to penetrate, but is vapour permeable. Make sure that the user is positioned correctly to avoid the risk of suffocation.
- 10 Prevent damage to the hygiene cover from sharp objects.
- 11 If the cover is equipped with side handles, these are for lifting the mattress. All other use takes place under your own liability and is not covered by the product guarantee.
- 12 In order to minimize the risk of wounds occurring on the feet, make sure that the user doesn't come into contact with the hangers of the pump.

1. Introduction

CuroCell® air mattresses operate according to the alternating pressure principle, a technique that is well proven and been used for a long time. Alternating pressure is when the pressure regularly alternates between the mattress cells to replicate body movement. Variable pressure cycles are set up where there is little or no pressure. This is optimal for skin improvement or to prevent skin damage.



Always read the user manual prior to use.

1.1 General information

This CuroCell® mattress is a medical device in accordance to Medical Device Regulation MDR (2017/745). According to statutory regulations made by the authorities regarding medical devices, the manufacturer is required to report all accidents or incidents involving these products. We would be very grateful for all information involving accidents or incidents relating to our products, by reporting them immediately to us, here at Care of Sweden. The system has been tested and approved according to the following standards: IEC 600601-1, IEC 60601-1-2, SS-EN ISO 12182, SS-EN ISO 14971, SS-EN ISO 10993, EN 597-1, EN 597-2.

1.2 Intended use

CuroCell Cirrus® 2.0 combines alternating pressure with soft foam and can be used in all types of health environments, to prevent pressure ulcers, and as an aid in the treatment of category 4⁽¹⁾(*). It is suitable for lightweight and sensitive people. The mattress has a built in heel function for added relief of heels and reinforced sidewalls for better stability. The mattress is placed directly on the bed.

Recommended user weight up to 230 kg.

Cleaning of the mattress shall be made between replacements of each user.

We recommend that position changes are made regularly. The time interval must be evaluated by the responsible personnel, depending on the user's status diagnosis and general condition.

NOTE!

- When used together with positioning pillows, read the pillow user manual carefully for correct positioning of the user.
- If you are using this product with an evacuation sheet/evacuation cover, it is the user's responsibility to ensure that it is safe to use for evacuation.
- Be careful when using bed rails or other protection on the bed so that the mattress does not become trapped or damaged.
- The mattress must not be lifted with a person lying on it or used for any other type of transport other than a possible evacuation using an evacuation sheet.
- This mattress is unsuitable for x-ray examinations because of the risk of blurred images or artefacts that may lead to diagnostics error.

(1) National Pressure Ulcer Advisory Panel, European Pressure Ulcer Advisory Panel and Pan Pacific Pressure Injury Alliance. Prevention and Treatment of Pressure Ulcers: Quick Reference Guide. Emily Haesler (Ed.). Cambridge Media: Osborne Park, Western Australia; 2014.

1.3 Other information

Action plan Pressure ulcers

For the best possible results when using this product, we recommend a structured and planned approach. Examples that can be applied to the use of our products can be found in the 'Action plan for pressure ulcers' guidelines.

Mattress guide

This guide provides guidance to personnel and prescribers when choosing a mattress from Care of Sweden. CuroCell Cirrus 2.0 is a mattress in function group C.

This information can be obtained from our website, www.careofsweden.com, or ordered from Customer Services (see contact information on the final page).

Evac-cover

A cover with protected zipper on all sides, divisible (top and bottom part). Functional handles for evacuation, moving and transport. Colour grey/black.

1.4 Evacuation instructions

Evac is a mattress cover with a built-in function for evacuation of bed-bound users. In case of fire or other emergency, there is no time to think about what to do next. Therefore, it is very important that the safety equipment, as well as the evacuation procedures, are well planned and known in advance.

The Evac cover is equipped with three handles on the head and foot end. On the sides, there are handles with Velcro straps. These straps are to be used to fixate the user to the mattress before commencing the evacuation. The straps are folded in the protective pockets on the side of the mattress with the ends sticking out to ensure that they are easy to pull out.

WARNING!

Person to perform an evacuation needs to have the necessary training. Always check the equipment, cover and mattress before commencing, to make sure an evacuation can be carried out safely. It is the user's responsibility to ensure that it is safe to use for evacuation.

Evacuation instructions

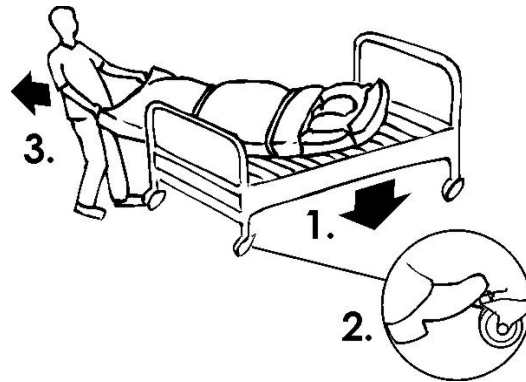
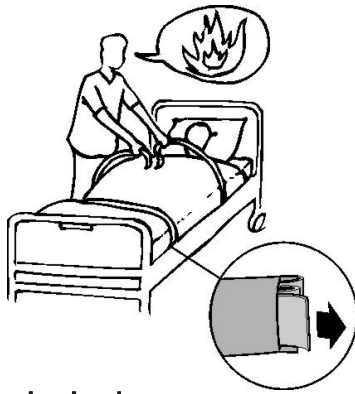

Down from the bed

- Inform the user about what will happen.
- Lower and lock the bed in position.
- Disconnect the tubes from the pump.
- Pull out and fasten the Velcro straps.
- Use the outer handles at the foot end of the mattress and turn the mattress out from the bed.
- Slowly pull the user down on to the floor.

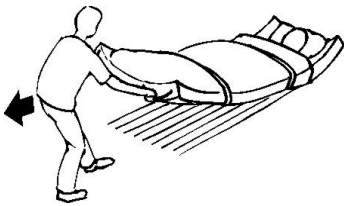

On an even surface

- Pull on the outer handles at the foot end of the mattress.
- Working position should be a little bit leaning back.

Down the stairs

- Walk backwards until the main part of the mattress has slide pass the top stair.
- Turn the back to the user and look in the moving direction.
- Hold one hand on the stair handle and pull with the other hand on the middle handle of the mattress.
- Walk down the stairs. It is important to maintain speed, without running.

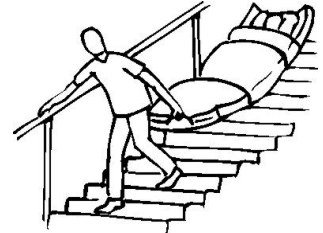

Training/practise

To bear in mind when training.

Pulling down from the bed:

- The user in the bed should not be at the very top of the mattress. There could be a risk of hitting the head in the bed when pulling down.

Pulling in the stairs:

- Start with pulling an empty mattress down the stairs, in order to practice the technique.
- When training with a person on the mattress, a string or rope can be fasten in the handles at the head end. Another person can then walk behind the mattress and help out if problems should occur.
- It is advisable to practice in the same stairs where an evacuation can be necessary.

General:

- The main purpose of the training is not to reach high speed, but to learn the correct technique.

Training covers

- Because of the heavy strain on the equipment when evacuating, always check the seams and handles at the end of training. We recommend that equipment used for training is marked with “Training equipment” and is only used for this purpose.

Explanations

- If the Velcro straps are not used, there is a risk of the user sliding/rolling down from the mattress.
- Pulling at the foot end reduces the strain on the puller, which means faster and safer evacuation is possible.
- Pulling in the stairs is the most difficult part of the evacuation and should be practiced extra carefully.
- The arms of the user shall be inside of the Velcro straps. This way reduces the risk of the user grabbing hold to something out of fear.

NOTE!

When using wider mattresses, make sure that the evacuation routes are clear (size of doors etc.). Responsible personnel have to ensure that the evacuation can be performed safely. To ensure proper function of the Evac cover, it is important to regularly check the quality of the mattress. Check for damages that could cause problems when evacuating.

2. Product description

2.1 Pump and mattress

CuroCell Cirrus® 2.0 has eight alternating air cells which are encased in HR-foam (high resilient foam). On top of the HR-foam, closest to the user, is a thin layer of visco-elastic foam.

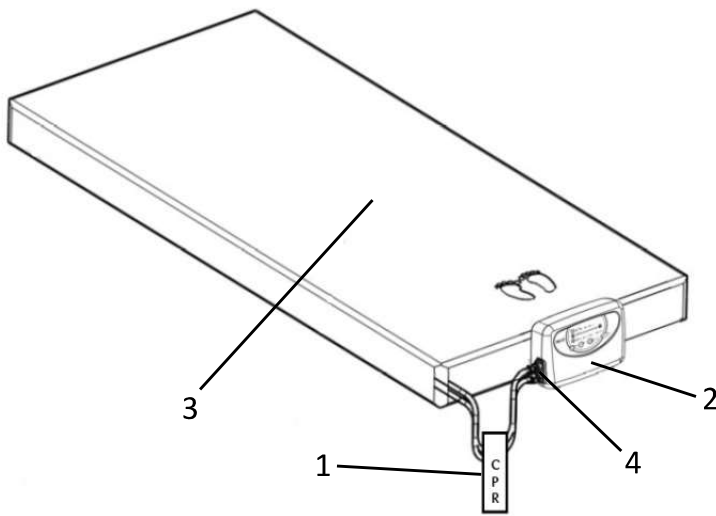

- 1. CPR (rapid deflation)
- 2. Pump
- 3. Mattress
- 4. Pump connector

- 1. Air cells
- 2. Foam core
- 3. CPR (rapid deflation)
- 4. Tubes

Cross-section of mattress

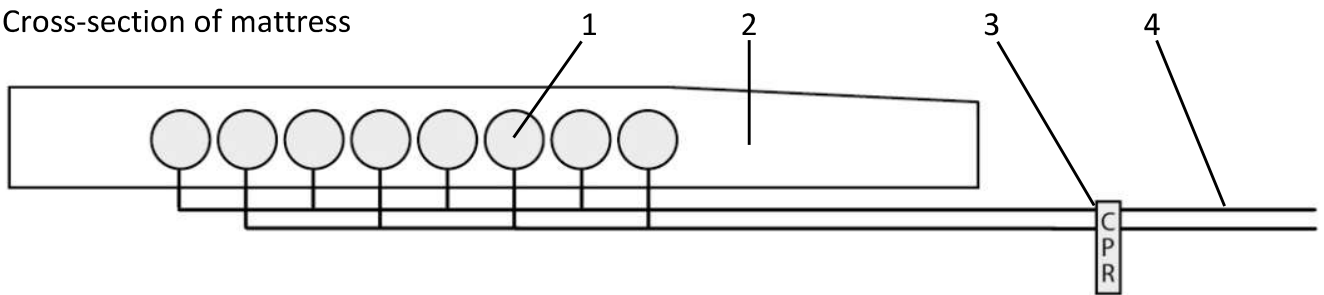

2.2 Pump

The CuroCell Cirrus® 2.0 pump applies alternating pressure that is adapted to the weight of the user. The air cells inflate and deflate with different cycle times.



- 1. Quick connector unit, air
- 2. Front panel

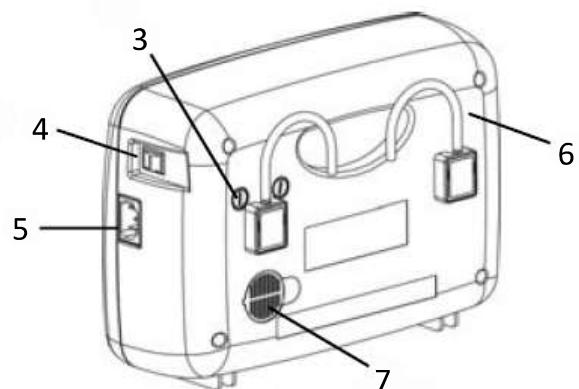

- 3. Fuses (2 pcs)
- 4. Off/On (0/1)
- 5. Power cord
- 6. Bed hooks
- 7. Air filter

2.3 Pump functions – control panel

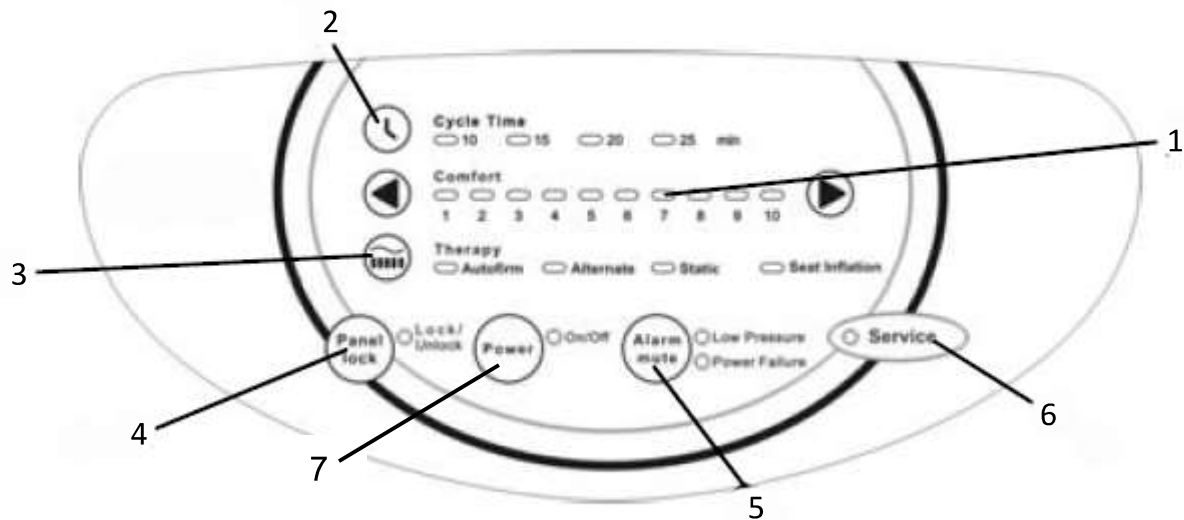

1 COMFORT – COMFORT SETTING

The appropriate air pressure is selected using the comfort arrows (1-10). Recommendations for different user weights are provided in a table on the pump.

2 CYCLE TIME

There are four selectable cycle times. Press the button to select cycle time.

3 PROGRAM (THERAPY)

Change the mode by pressing the button, the chosen mode is indicated by the green light. The modes' order is: Autofirm, Alternate, Static, Alternate - seat inflation, Static - seat inflation.

A. Autofirm Autofirm is used to fill the mattress with air completely for firm support. The pump always starts in this mode. When the correct pressure is reached, it changes automatically to the previous setting or to the presetting outlined below.

Presetting features for Autofirm process

1. Program (Therapy): Select the required program.
2. Comfort setting: Set the required air pressure (1-10).
3. Cycle time: Select from 10, 15, 20 or 25 minutes.

Note: The preset Cycle Time, Comfort Level and Therapy mode will be illuminated to indicate the settings during the Autofirm process. (Autofirm LED is also illuminated.) After mattress is inflated, Autofirm LED will be turned off automatically.

B. Alternate In this mode, the pressure alternates between the cells and there are four different cycle times to choose from.

C. Static When "Static" is chosen, the alternating process is terminated and the pressure between the cells evens out. The function can be used in association with user care, repositioning/transferring in and out of bed. The function is turned off by pressing the button again, or it will automatically go back to alternating mode after 20 minutes.

D. Seat inflation This mode gives extra support when sitting up and can be set for both alternating and static mode.

4 PANEL LOCK

Press down the Panel lock button for about 2 seconds to lock or unlock the panel.

5 ALARM MUTE

Press the ALARM MUTE button to temporarily turn off the alarm. Should the situation not be resolved within 5 minutes, the alarm will be activated again. Please refer to section 8 to troubleshoot any problems with the alarm.

A. Power failure alarm

During a power failure, both the sound and light alarm will go on. Turn it off by pressing the ALARM MUTE button.

B. Low pressure alarm

When the low pressure light is on, the pressure in the mattress is below normal. Both the light and sound alarm will activate. The alarm will sound until the ALARM MUTE button is pressed. If the problem remains, see chapter 8 for trouble shooting.

6 SERVICE

This light indicates a technical failure in the pump. First check that the air filter is clean and that the pump is not covered by anything (such as a pillow or a blanket). If the problem remains, please contact the manufacturer or your local dealer for further information.

7 POWER

Power on/off.

3. Assembly/Installation

When unpacking the mattress, check that none of the parts are damaged. In the event of damage, contact your distributor before using the product.

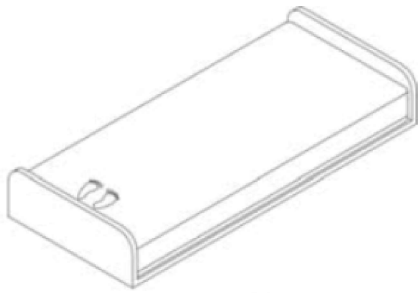

1. Place the mattress on the bed base.

Note!

- Make the bed with sheets for added comfort.
- Check that the CPR valve is closed.

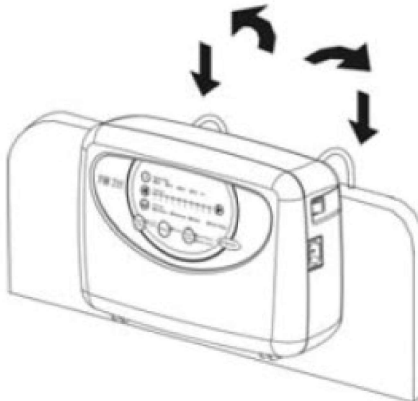

2. Hang the pump at the foot end of the bed or place it on a flat, sturdy surface.

Route the power cord so that there is no risk of it causing someone to trip, being run over by the bed wheels or getting pinched when the bed is raised or lowered.

If a cable holder is used (optional): open the press studs, position the power cord in the pocket and close the press studs.

Note! In order to minimize the risk of wounds occurring on the feet, make sure that the user doesn't come into contact with the hangers of the pump.

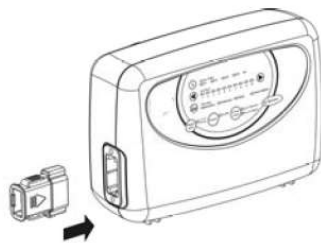

3. Connect the air tubes from the mattress to the side of the pump. There is an audible "click" sound when the quick connectors are properly attached.

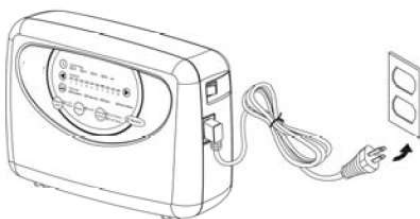

4. Check that the switch on the pump is in the "0" position (Off). Connect the plug to an approved electrical socket (220 V).

4. Operation



Note! Always read the user's manual prior to use.

4.1 Start-up

1. Start the pump by pressing "1" (On) on the side of the pump, as well as pressing the 'Power' button on the front panel.
2. Air starts to fill up the mattress. It takes about 15 minutes until the mattress is ready for use.

Note! The pump always starts in Autofirm mode.

3. The light for 'Low pressure' is lit until the mattress has reached the set pressure. When the light goes out, the system changes mode (to previous settings) and the mattress is ready to be used.



4.2 Program selection

There are four different programs. Please refer to section 2.3 for more details. As a standard setting, we recommend an alternating mode and a 10 minute cycle time.

4.3 Comfort settings

The air pressure in the mattress can be adjusted according to the user's desire for comfort. ALWAYS consult the prescriber or other authorised personnel for the appropriate setting.

The mattress is now ready for use. Use the comfort buttons (1-10) to set a suitable air pressure based on the table on the pump.

Note! The pump always starts in the Autofirm mode. When the mattress has reached the required pressure, the pump is set automatically to the previously used setting or to the settings made in the Autofirm program. Please refer to section 2.3 for more details.

kg	
0-44	1
45-54	2
55-64	3
65-74	4
75-94	5
95-114	6
115-144	7
145-164	8
165-184	9
185-230	10

NOTE!

- We recommend the Seat inflation mode for all situations where the head of the bed is raised.
- When only parts of the mattress are under load, e.g. if the user is an amputee, the pressure should be increased (1-2 levels).
- Always check the set pressure with a "hand check", see 4.4 for more information.

4.4 Hand check (function control)

Hand check is used to ensure that the mattress is properly inflated. This should be done regularly, once per shift and after changing the position in the bed or changing the comfort settings.

Insert your hand between the air cells directly underneath the user's pelvic region, use a vertical hand. There should be a clearance of 2-3 fingers between mattress base and the user. If not, you need to adjust the pressure setting.

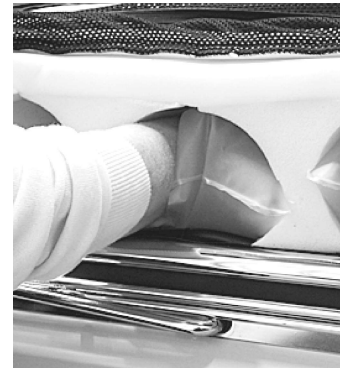

4.5 CPR

To empty the air cells, pull the CPR (cardiopulmonary resuscitation) band placed between mattress and pump. In case of an emergency where CPR is necessary, follow local instructions.

Note! Make sure that the CPR connector is properly connected after use.



4.6 Alarms

When the pressure drops to an abnormally low level, the Low Pressure diode lights up together with an audio alarm. Please refer to section 8 for troubleshooting. The alarm is deactivated by pressing the ALARM MUTE button on the pump's control panel. If the problem is not resolved within 5 minutes, the alarm will start again. The diode remains on until the pressure level is remedied and reset.

The pump is also fitted with a Power Failure alarm. An alarm sounds and flashes when the pump is disconnected from the electric power. Turn off the alarm by pressing the 'ALARM MUTE' button.

WARNING!

If the air pressure remains low, check the mattress and tubes for damage. Repair if necessary or contact the manufacturer or your local dealer for help.

4.7 Transport function

If the user must be moved in bed, the tubes can be connected together (detached from the pump) and the mattress is put in "transport mode". We recommend that this function is only used for short periods of time.



5. Cleaning and reconditioning

It is important to follow the instructions below before using the product for another user. Consult the Clinician responsible or the supplier for help and instructions when unsure.

5.1 Cleaning

PUMP

WARNING!

- Do not open the pump housing – risk of electric shock. Service and maintenance must be performed by authorised technicians.
- Do not get the pump wet or submerge it in any liquid.



Wipe of the pump with a damp cloth and a mild cleaning solution for this purpose such as: alcohol with or without tensides, Isopropanol 70 %, oxidating solutions or chlorine max 1 %. If using a different agent, choose one that does not affect the pump housing.

MATTRESS COVER



Covers can be wiped off with a mild cleaning solution for this purpose such as: alcohol with or without tensides, Isopropanol 70 %, oxidating solutions or chlorine max 1 %. Excrements and blood spots must be removed immediately with cold water.

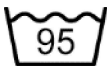

Multi-layer covers should be divided before washing. Wash with similar colours.



Chlorine and phenol-based cleaners could have a negative impact on the PU surface and should be avoided. If chlorine is used, we recommend a mixture of max. 1%.

INNER COVER ELASTIC

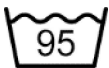

Clean the affected area with a mild cleaning solution for this purpose such as: alcohol with or without tensides, Isopropanol 70 %, oxidating solutions or chlorine max 1 %.

5.2 Reconditioning

PUMP

See section 5.1 for instructions.

MATTRESS

1. Remove the covers. See instructions in chapter 5.1 for cleaning covers.
2. Disconnect the tubes from the pump.
3. Carefully pull the air cells out from the foam core. Note! Be cautious when handling the sidewall.
4. Place the air cells and the tubes on a clean area which is suitable for washing.
5. Wipe off the cells, all tubes and the CPR valve with a mild cleaning solution for this purpose such as: alcohol with or without tensides, Isopropanol 70 %, oxidating solutions or chlorine max 1 %.
6. Place the air cells back into the foam core. Check that all the tubes and connectors are secure and tight, before closing the cover.
7. Wipe off work surfaces with a mild cleaning solution for this purpose such as: alcohol with or without tensides, Isopropanol 70 %, oxidating solutions or chlorine max 1 %. If cells for any reason have loosened from the tubes, these must be replaced according to drawing in chapter 2.1

FOAM CORE



Clean the affect area with a mild cleaning solution for this purpose such as: alcohol with or without tensides, Isopropanol 70 %, oxidating solutions or chlorine max 1 %.

Press out the water carefully. Let the foam core dry in a warm, ventilated area, without direct exposure of sunlight. The foam core needs to be completely dry before it is used again.

NOTE!

Check the hygiene cover each time the product is cleaned. If damaged, it must be replaced or repaired. Also check the pump, tube connectors and power cord during cleaning. Damaged parts must be replaced or repaired.

6. Storage

Store the mattress on a flat surface or carefully rolled/folded with the zipper closed. Always store at room temperature in a dry area. Make sure the mattress is stored where it will not be exposed to thrusts, impact or other things that can damage it. Avoid direct exposure of sunlight. If the mattress is to be stored more than 3 months, we recommend it is stored on a flat surface (not folded or rolled up).

7. Maintenance

7.1 General

1. Check the power cord and plug for damage and scratches.
2. Check that the mattress cover is intact and that the cover and air cells are correctly assembled.
3. Check that the air flow alternates between each outlet on the side of the pump.
4. Check for damaged or pinched tubes and connectors. Contact the manufacturer or your local dealer for spare parts.

7.2 Changing fuses

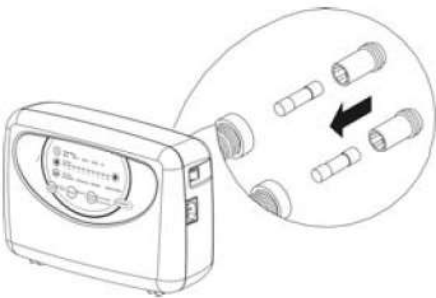

1. Pull the plug out of the electrical socket before replacing fuses.
2. Remove the cover from the fuses with a screwdriver. Pull out the fuse holder.
3. Fit a new fuse of the same type (T1A/250V) and screw the protective cover back in place. There are two fuses.

7.3 Changing the air filter

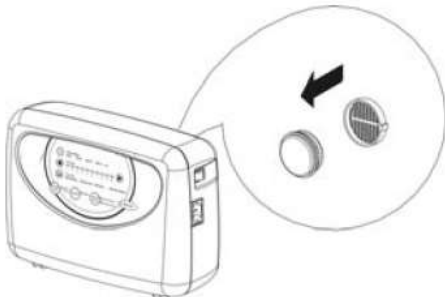

1. Unscrew the round safety plate on the back of the pump.
2. Lean the pump backwards in order for the filter to fall out from the holder.
3. Place the cleaned/new filter in the filter holder and replace the safety plate.

If the pump is used in a dirty environment, the filter should be checked regularly.

8. Troubleshooting

Problem	Solution
Pump does not start	<p>Check that the power cord is connected to an approved electrical socket.</p> <p>Check the fuses.</p> <p>Make sure the power switch on the pump side is set to “1”.</p>
Alarm is on and mattress is losing air	<p>Check that the quick connectors on the air tubes are properly connected to the side of the pump.</p> <p>Check that the CPR valve is closed.</p> <p>Check that all tube connectors are properly seated and connected.</p> <p>Open the mattress and check for leaks from air cells or tubes.</p>
The user is bottoming out	<p>The pressure might be incorrectly set. Adjust according to the weight table and wait a few minutes. Check again using a hand check (see section 4.4).</p> <p>Check that the CPR valve is closed.</p>
Some cells have less air	<p>This is normal since the cells are alternately inflated and deflated when the system is set to alternating mode.</p>
Pump is noisy, vibrations are felt	<p>Check that the pump hangs correctly on the bed. Resonance can occur in parts of the bed. Remove the pump and listen whether this makes a difference. Can be resolved by putting the pump on a flat, steady surface or by placing a towel between the pump and bed.</p>
<p>If your questions are not answered by the above information, please contact the manufacturer or your local dealer.</p>	

9. Technical key

9.1 Technical specification

PUMP		SPECIFICATION
Model		CuroCell Vari
Voltage		220 V-240 V / 50-60 Hz
Current consumption		0.07 A
Fuse type		T1A/250V
Cycle time		10, 15, 20 or 25 min
Dimensions (BxLxH)		29.1 x 11.7 x 20 cm
Weight		2.2 kg
Surroundings	Temperature	Operations: 10°C - 40°C Storage: -15°C - 50°C Shipping: -15°C - 70°C
	Humidity	Operations: 10% - 90% non-condensing Storage: 10% - 90% non-condensing
	Athmospheric pressure	700hPa-1060hPa
Classification		Class II, Type BF, IP41
MATTRESS		SPECIFICATION
Model		CuroCell Cirrus® 2.0
Dimensions (BxLxH)		80/85/90/105/120x200x21 cm
Weight		18 kg (width 85 cm)

NOTE: The manufacturer retains the right to modify the product specification at any time.

WARNING!

Follow the operations and maintenance instructions carefully in order to prevent bodily injuries, as well as damages to the product or other equipment.

9.2 Labelling

The mattress is labelled with product name, production date, article number, size, care and wash instructions, EAN-bar code, as well as space for own labelling. The product also displays which side is up/down and head/foot.

9.3 Symbol Definitions



Article No



Manufacturer

XXXX-XX-XX

Year-Month-Day



Foot placement



Read the user manual



Group of function



CE marked acc. to Medical Device Regulation MDR (2017/745)



Recycling



Do not dispose of with household waste; follow recycling instructions



Recommended user weight



User information - category



Directly on bed base



Recommended user weight when using Evac function



Counteract shear force



Heel function



Do not wash

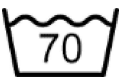

Machine wash at 70 °C

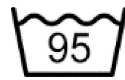

Machine wash at 95 °C



<1% Chlorine



Tumble dry



Do not tumble dry



Drip dry



Do not iron



Do not dry clean



Wipe off



Class II equipment (Double Insulated)



Type BF



IP-class (Ingress Protection Rating)



Temperature range

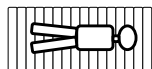

The mattress should only be used lying in the lengthwise direction on the



Distributed by



Medical Device



UDI

10. Spare parts

Cover Stone/Evac

Size	Art. no. Top part Stone	Art. no. Bottom part Evac	Art. no. Complete Stone/Evac
80x200 cm	CC-926010	CC-926210	CC-925810
80x210 cm	CC-926011	CC-926211	CC-925811
85x200 cm	CC-926012	CC-926212	CC-925812
85x210 cm	CC-926013	CC-926213	CC-925813
90x200 cm	CC-926014	CC-926214	CC-925814
90x210 cm	CC-926015	CC-926215	CC-925815
105x200 cm	CC-926016	CC-926216	CC-925816
105x210 cm	CC-926017	CC-926217	CC-925817
120x200 cm	CC-926018	CC-926218	CC-925818
120x210 cm	CC-926019	CC-926219	CC-925819

Art. no.	Description
CC-901801	Air cell for mattress width 80 cm
CC-901802	Air cell for mattress width 85 cm
CC-901803	Air cell for mattress width 90 cm
CC-901804	Air cell for mattress width 105 cm
CC-901805	Air cell for mattress width 120 cm
CC-8217	Fuse (set of 2)
CC-8202	Air filter

If other spare parts are needed, please contact your distributor.

11. Accessories

Inner cover Elastic

Art. no.	Size	Art. no.	Size
CC-928230	80x200x20 cm	CC-928235	90x210x20 cm
CC-928231	80x210x20 cm	CC-928236	105x200x20 cm
CC-928232	85x200x20 cm	CC-928237	105x210x20 cm
CC-928233	85x210x20 cm	CC-928238	120x200x20 cm
CC-928234	90x200x20 cm	CC-928239	120x210x20 cm

Top part CuroCell LF (low friction) - Top part with increased sliding function, can be used for example heavy, immobile users.

Top part CuroCell LF (low friction)

Art. no.	Size	Art. no.	Size
CC-916210	80x200	CC-916215	90x210
CC-916211	80x210	CC-916216	105x200
CC-916212	85x200	CC-916217	105x210
CC-916213	85x210	CC-916218	120x200
CC-916214	90x200	CC-916219	120x210

Art. no.	Size
58-900905	Transport bag 105-120 cm
58-900906	Transport bag, extra high, 80-90 cm
58-900911	Transport bag, extra high, 105-120 cm

To ensure the best level of comfort, we recommend use of accessories from Care of Sweden since our products are designed to work well together. Please contact Care of Sweden or your local dealer for accessories or more information on our products.

12. Warranty

12.1 Scope

This CuroCell® system is covered by a 2-year warranty for manufacturing defects. The warranty does not apply to normal wear and tear or damage due to negligence or improper handling/care.

12.2 Service and maintenance

This CuroCell® mattress is a medical device, in accordance with Medical Device Regulation MDR (2017/745), that is used as an aid in preventing and treating pressure ulcers. For this reason, we recommend that the pump be regularly serviced and inspected to maintain functionality and performance. Like other technical devices, a pump that is properly cared for works better and lasts longer.

Service and maintenance must always be performed by an authorised technician. Only use spare parts that have been approved by the manufacture, use of non-approved spare parts invalidates the warranty.

A warranty claim must be submitted to the manufacturer or your distributor before the product is returned.

Please contact the manufacturer or your distributor if you have any questions regarding warranty and services.

12.3 Life expectancy

This products expected life is estimated to be 5 years.

13. Other information

13.1 Disassembly and recycling

Except for certain parts of the pumps, energy recovery is possible for almost all material in CuroCell® products through incineration in waste incineration facilities.

Pump:

A used CuroCell® pump must not be disassembled. It must instead be taken to a recycling centre and sorted as electronic waste.

Mattress:

A used CuroCell® mattress must be taken to a recycling centre and sorted as combustible waste.

For more information contact the manufacturer or your distributor.

13.2 Returns and complaints

Complaints are to be reported to the supplier. Return of a product shall follow the supplier's instructions and can only be done after the complaint has been reported. Damages due to the transportation should be reported to the transportation agent.



Manufactured by

 care of sweden

SUPPORTING LIFE

Contact:

Phone: + 46 771 106 600

Fax: + 46 325 128 40

Email: export@careofsweden.se

Internet: www.careofsweden.com

Address:

Care of Sweden AB

P.O. Box 146

SE-514 23 Tranemo

SWEDEN

Visit address:

Fabriksgatan 5A

SE-514 33 Tranemo

SWEDEN

Cargo address:

Byns väg 4A

SE-514 33 Tranemo

SWEDEN

Supplied by